

# 157 ACRE RANCH IN LINCOLN, CA

## Beautiful Coon Creek Bottomland in Placer County



APN: 020-145-019 & 020-145-016

Zoned: Agricultural

Size: 157 acres

Parcel 016: 117 acres

Parcel 019: 40 acres

Located: North Kilaga Spring Road off of Kilaga Springs Road from McCourtney Road near Riosa Road.

Beautiful bottomland with Coon Creek running through the 117 acre parcel. Incredible view, home sites overlooking grazing land and the Sutter Buttes.

**SALE PRICE: \$1,570,000**



The Vollman Company  
Commercial Real Estate Brokerage  
11500 Sunrise Gold Circle, Suite E  
Rancho Cordova, CA 95742  
[www.thevollmancompany.com](http://www.thevollmancompany.com)

License # 02091276

**Dan Mincher, CCIM (916) 833-3763 cell**  
[dmincher@thevollmancompany.com](mailto:dmincher@thevollmancompany.com)

# 157 ACRE RANCH IN LINCOLN, CA

## Beautiful Coon Creek Bottomland in Placer County

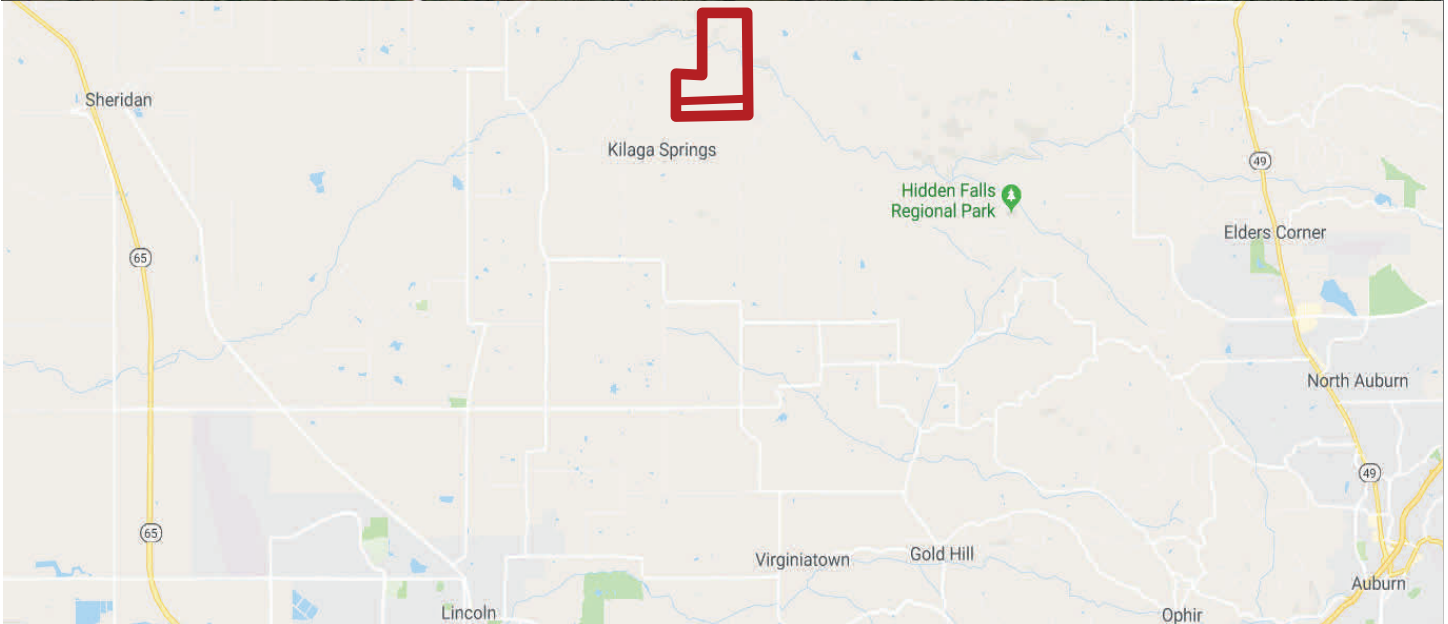

The Vollman Company  
Commercial Real Estate Brokerage  
11500 Sunrise Gold Circle, Suite E  
Rancho Cordova, CA 95742  
[www.thevollmancompany.com](http://www.thevollmancompany.com)

License # 02091276

Dan Mincher, CCIM (916)833-3763  
[dmincher@thevollmancompany.com](mailto:dmincher@thevollmancompany.com)